

**NEW**

# Showerdec® Concrete & Solid Floor Fitting Instructions

**IMPORTANT  
PLEASE  
READ**

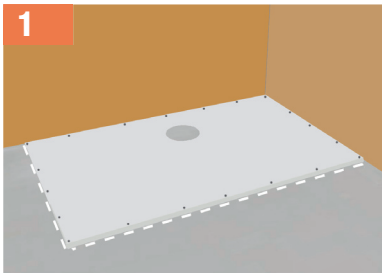

1 Locate ShowerDec® in the corner to which it is going to be finally positioned & mark lines around the outer edge.

If cutting to size use a circular saw or jigsaw.

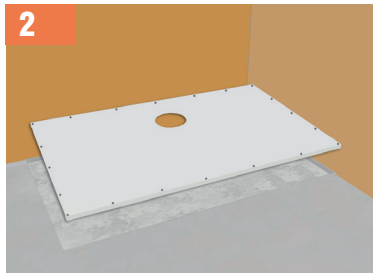

2 Excavate the floor within the marked area to a sufficient depth of **24mm** to accept ShowerDec®.

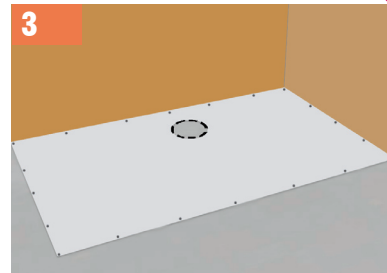

3 Ensure ShowerDec® fits neatly into the recess. Mark shower trap position.

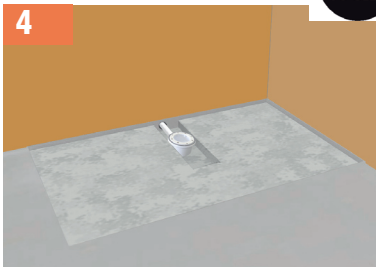

4 Remove ShowerDec®. Decide upon the position of the waste pipe knocking out a hole in the adjacent wall if required. It will be necessary to remove an area to sufficient depth under the outlet position to accommodate the shower trap. (Approximate trap depth 95mm x 110mm wide).

**The trap must be fully supported underneath with a self levelling screed mix.**



There are two methods of attaching the trap

### METHOD 1 (As shown in points 5 & 5a)

Set the trap body into the floor. Place the trap flange into ShowerDec® ensuring it finishes flush with, or just below the surface on which the sheet flooring is to be laid. Attach flange to the trap body using the 4 bolts provided, ensure the rubber seal is in place. Secure flange to ShowerDec®, there are 4 off csk indentations in the flange to assist with this. Connect trap to waste pipe for outflow drain.

### METHOD 2

Fully assemble the trap to ShowerDec® (as described above) before placing in position, also attaching a length of pipework ready for connection to the waste / soil pipe.

**If you are using a pump, the fitting of the shallower pumped trap is the same as described above.**

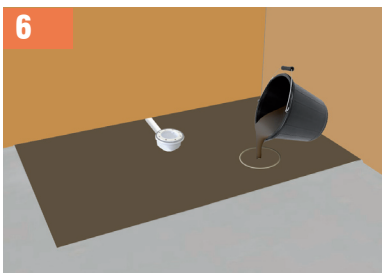
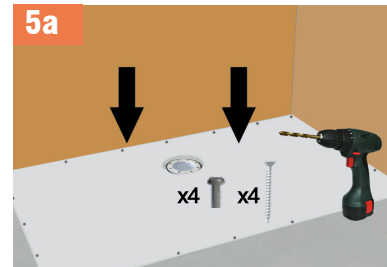

6 Apply a self levelling screed mix to cover all of the proposed area. This will ensure ShowerDec® is fully supported.

**Caution!** Ensure the void around the trap body is also filled. **DO NOT** rely solely on support from under the flange.

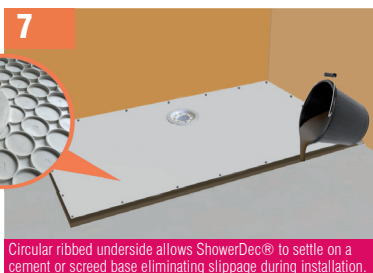

Circular ribbed underside allows ShowerDec® to settle on a cement or screed base eliminating slippage during installation.

7 Carefully place ShowerDec® into position. Checking levels in both directions, gently tap ShowerDec® down until level on all 4 sides. It may be necessary to add more self levelling screed, do this by slightly lifting ShowerDec® & pouring in the screed. Gently tap again until level on all 4 sides.

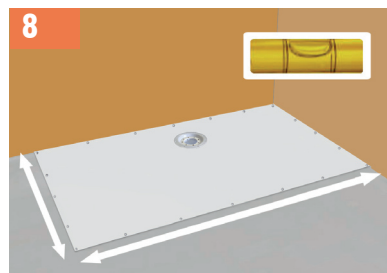

8 It is **important** that ShowerDec® is level on all 4 sides when fitted & then left to set.

**TIP:** Filling the ShowerDec® / floor joint & the screw ports using a resin car body filler or similar will form a strong bond between Showerdec® & the bathroom floor as well as prevent indentations appearing in the floor covering.



9 At this stage you will now be ready to bond into position the relevant coverings & floor coverings.

**NOTE:** Bond vinyl sheet flooring to the floor using a 2 part water resistant adhesive. All flooring should be installed in accordance with the manufacturers guidelines.

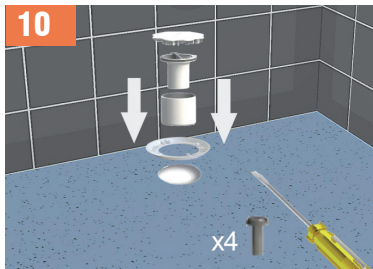

10 Once the floor covering is laid, screw into position the trap clamping ring using the bolts provided, ensuring the inner cup & dip tube can still be removed. Fit the shower traps push on cover plate.

**You can now install your chosen shower enclosure.**

**Technical Helpline:  
0845 402 9924**

**NOTE:** If fitting a pumped trap follow the above instructions with the exception of installation of the trap itself, Point 5 & 6. The trap is a one part trap fed through from the top of the ShowerDec®.



Issue 4 APR 2017

Contour Showers, Siddorn Street, Winstford, Cheshire CW7 2BA	
16 CS-CPR-14527-09	
SM PH EN 14428:2015 CL 2	



1 Locate ShowerDec® in the corner to which it is going to be finally positioned and mark lines around the outer edge.

If cutting to size use a circular saw or jigsaw.

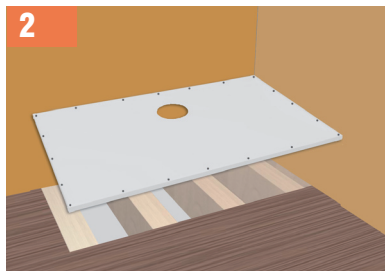

2 Remove the floor within the marked area to a depth of 18mm to accept ShowerDec®.

**Ensure the joists provide a secure and flat surface for the ShowerDec®.**

It may be necessary to use packing on the joists to ensure the ShowerDec® is level.

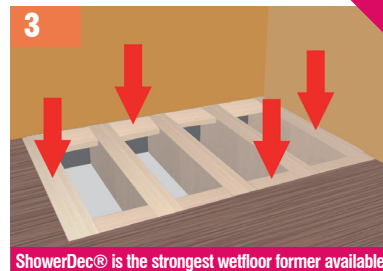

3 ShowerDec® is the strongest wetfloor former available **297kg MAX LOAD CAPACITY (46 STONES)**

Use noggins to support all outer edges of the ShowerDec® as shown above.

**IT IS NOT NECESSARY TO USE ADDITIONAL NOGGINS AROUND THE WASTE POSITION.**

**NOTE:** If the floorboards are **18mm** thick you would need **6mm** plywood to make the ShowerDec® and floor absolutely level in order to apply your floor covering.



4 Connect the trap body to your outlet pipework, position between joists and centrally beneath the hole in the ShowerDec®.

**Ensure the trap is fully supported underneath.**



5 Place the ShowerDec® in position.

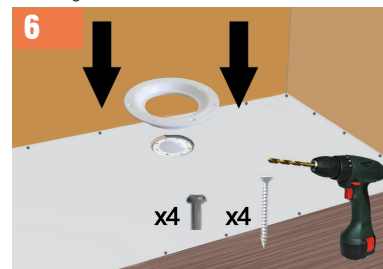

6 Attach flange to the trap body using the 4 bolts provided, ensuring that the rubber seal is in place. Secure flange to ShowerDec®, there are 4 countersunk indentations in the flange to assist with this.



7 Also ensure that the flange on the trap body is level with, or slightly below the ShowerDec® once in its correct position and that the rubber seal is in place.

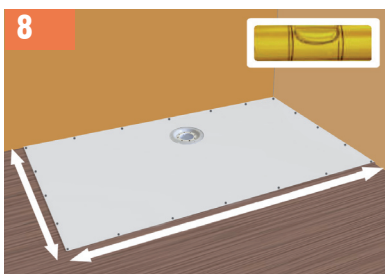

8 Ensure that the ShowerDec® is well supported and completely level.

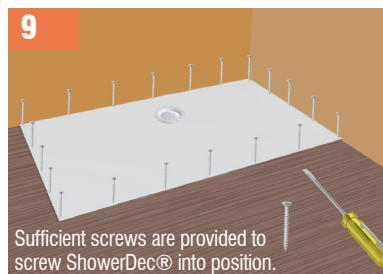

9 Sufficient screws are provided to screw ShowerDec® into position.

Use the longer screws provided to secure the ShowerDec® to the floor joists. Ensure ShowerDec® is secured along all 4 edges to eliminate any movement.

**IT IS NOT NECESSARY TO PILOT DRILL THROUGH THE SCREW PORTS.**

**TIP:** Fill the joint, using a resin car body filler or similar to form a strong bond between the ShowerDec® & the floor.



10 At this stage you will now be ready to bond into position the relevant coverings and floor coverings.

**NOTE:** Bond vinyl sheet flooring to the floor using a 2 part water resistant adhesive. All flooring should be installed in accordance with the manufacturers guidelines.

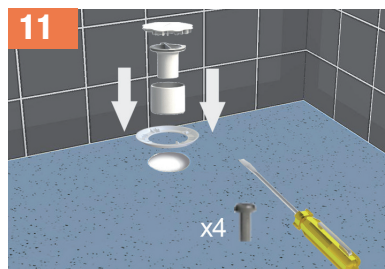

11 Once the floor covering is laid, screw into position the traps clamping ring using the bolts provided ensuring the inner cup and dip tube can still be removed.

Fit the shower traps push on cover plate.

**You can now install your chosen shower enclosure.**

**Technical Helpline:  
0845 402 9924**

**NOTE:** If fitting a pumped trap follow the above instructions with the exception of installation of the trap itself, Point 4 & 6.

The trap is a one part trap fed through from the top of the ShowerDec®.

